

TEMPUR FORM™ Bed range

ASSEMBLY GUIDE

Contents:

TEMPUR FORM™ Static Boxspring bed assembly guide	4
TEMPUR FORM™ Adjustable Boxspring bed assembly guide	11
Headboard assembly guide	20

Welcome to TEMPUR®

Thank you for choosing a TEMPUR® product!

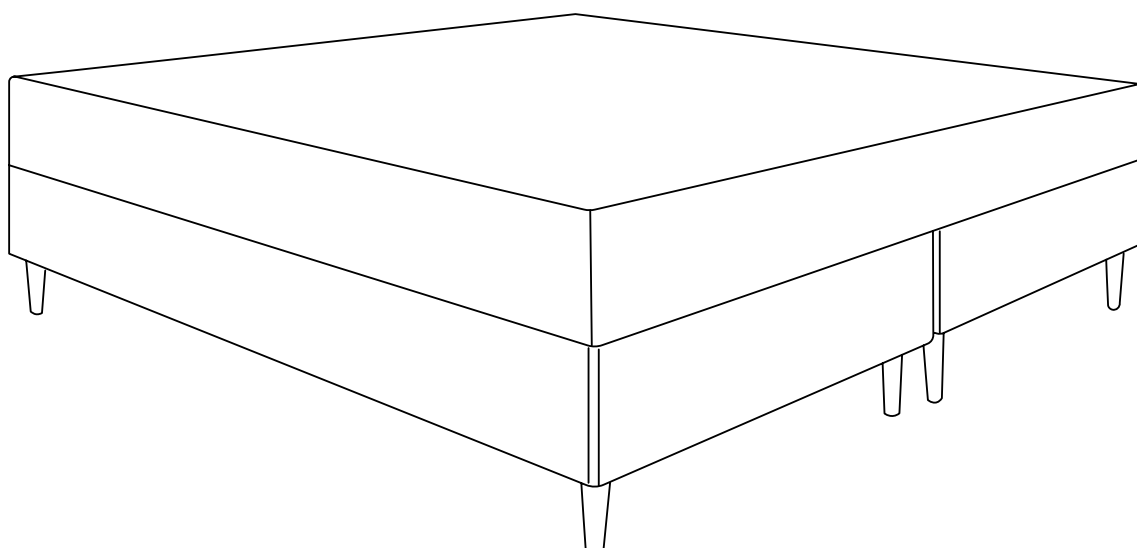
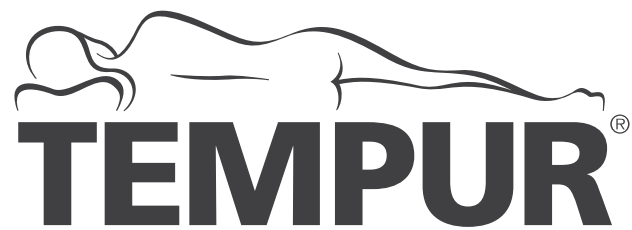

TEMPUR FORM™ Bed range

Static Boxspring bed assembly guide



CAUTION

The assembly instructions must be followed closely to install the bed system successfully, safely, and to minimize the risk of personal injuries and damage to the product.



Assemble the product with a minimum of two people.



Open the packaging carefully to prevent causing damage to the product. Dispose of the packaging safely and as sustainably as possible in your local area.

Component list

Check all the components. No tools are needed for the assembly.

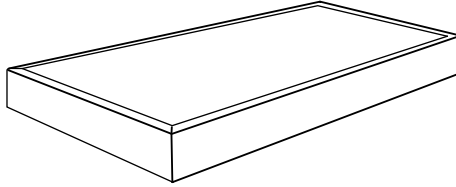

2x bed base



8x legs

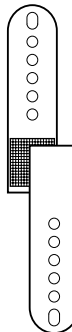

2x connector sets

IMPORTANT

Check for the holes at the head-end of the bed base. These are for connecting the headboard to the bed base if you opted for one.

These holes also mark the head-end of the bed frame.

During the assembly it's important to determine the head-end and foot-end to install correctly the connector set between the two bed frames.

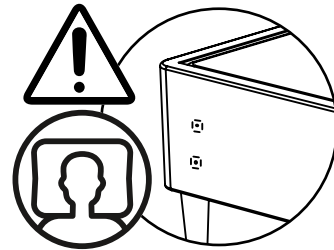

1. Turn one half of the base onto it's side to assemble, ensuring one person is safely holding the base at all times.

IMPORTANT

Please be aware of the location of the headboard holes and position the base accordingly in the room. For the first half of the bed, keep the headboard side on the right when turning the bed base onto it's side.

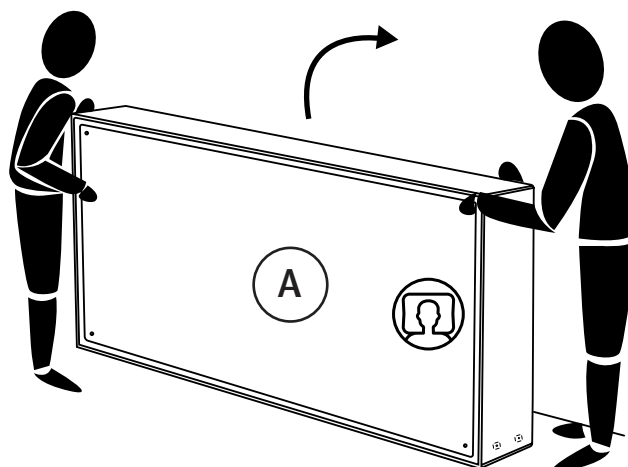

2. Attach the legs and connector sets to the first bed half.

There are two connectors which need to be positioned on the upside edge of the first frame. For the first half of the base place the connector with the velcro side down. Then screw the leg through the third hole from the straight edge of the connector and turn the leg until securely tightened. Then install the final two legs on the lower side of the base, these do not require connectors. Once this is completed, safely turn the bed base over onto it's legs.

IMPORTANT

Use one connector set for head-end and other one for foot-end.

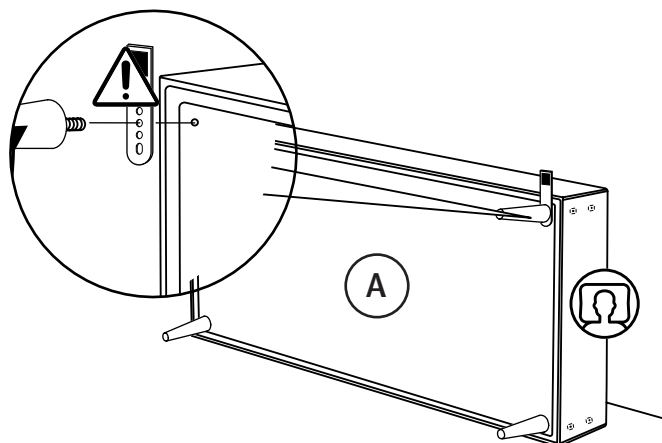

3. Turn second half of the base onto it's side to assemble, ensuring one person is safely holding the base at all times.

IMPORTANT

Please be aware of the location of the headboard holes. For the second half of the bed, keep the headboard side on the left when turning the bed base onto it's side.

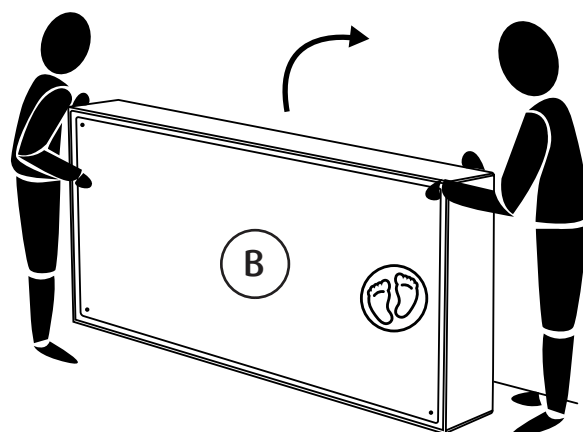

4. Attach the legs and connector sets to the second bed base.

There are two connectors which need to be positioned on the upside edge of the second frame. For the second half of the base place the connector with the velcro side up. Then screw the leg through the third hole from the straight edge of the connector and turn the leg until securely tightened. Then install the final two legs on the lower side of the base, these do not require connectors. Once this is completed, safely turn the bed base over onto it's legs.

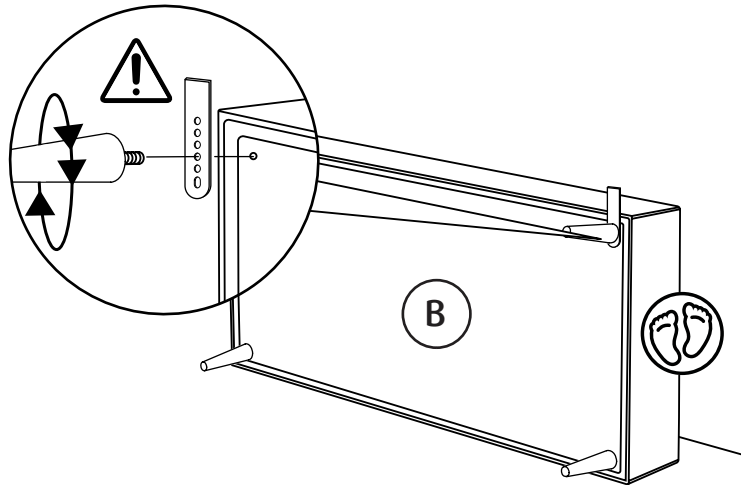

5. Connect the two bed bases together.

Using two people put both bed bases on an even surface with the connecting plates facing each other. Push the beds together and then overlap the connectors to link the velcro pads. Push the velcro pads together to secure.

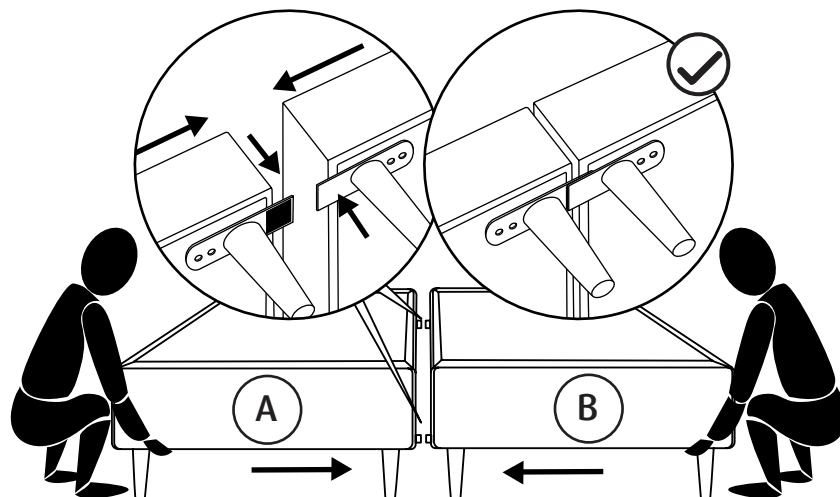

6. Once the connectors are in place, you are now ready to place the mattress onto the bed.

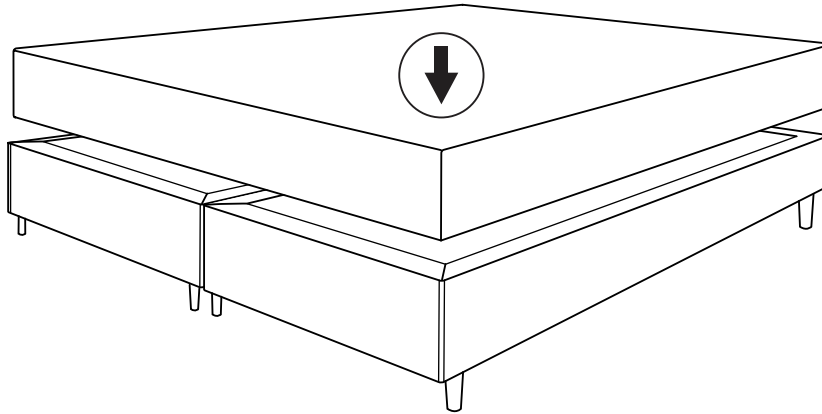

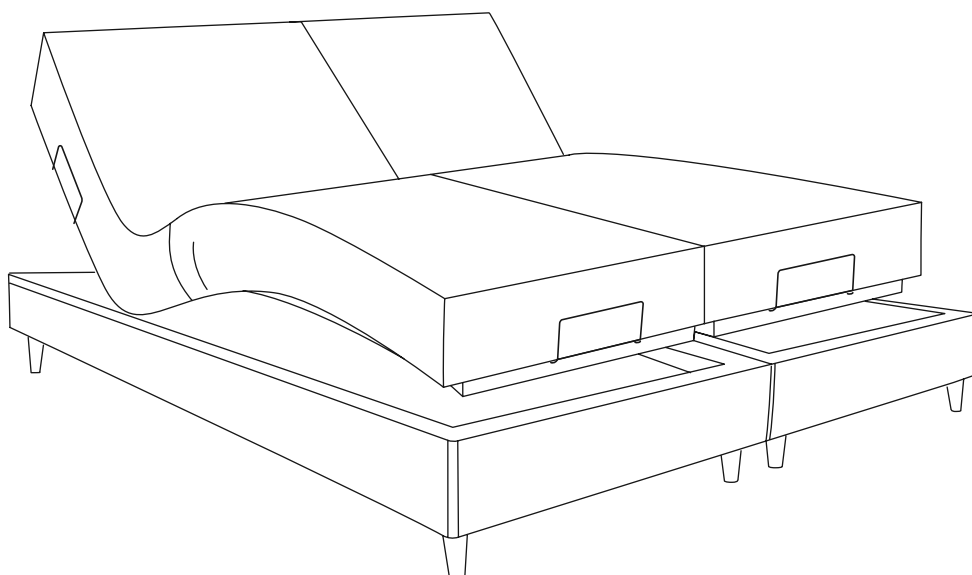
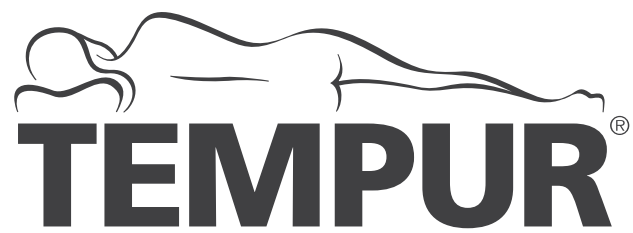

TEMPUR FORM™ Bed range

Adjustable Boxspring bed assembly guide



CAUTION

The assembly instructions must be followed closely to install the bed system successfully, safely, and to minimize the risk of personal injuries and damage to the product.



Assemble the product with a minimum of two people.



Open the packaging carefully to prevent causing damage to the product. Dispose of the packaging safely and as sustainably as possible in your local area.

Component list

Check all the components. No tools are needed for the assembly.

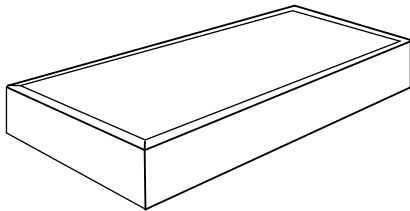

2x bed base



8x legs



2x foot-end mattress retainer

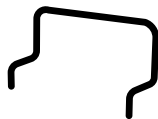

2x side mattress retainer

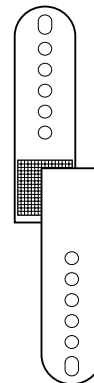

2x connector sets

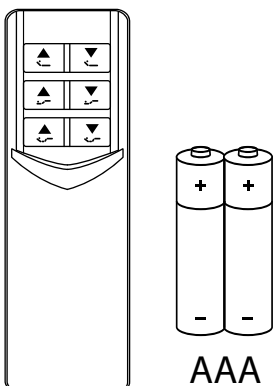

2x remote control with
batteries

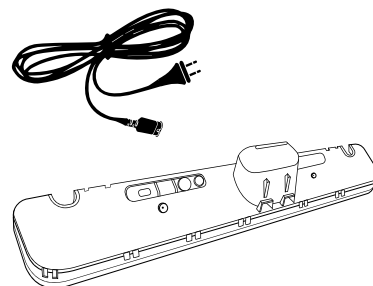

2x motor with power cord

1. Install the legs and connector sets.

Using two people, position both bed bases upside down on an even surface. Make sure head-ends face the same direction.

Attach the connectors to left side of left hand bed base and to the right side of the right half of the bed base.

For the first half of the base place the connector with the velcro side down.

Then screw the leg through the fifth hole from the straight edge of the connector and turn the leg until securely tightened. Then install the two legs on the other side of the first base, these do not require connectors.

For the second half of the base place the connector with the velcro side up. Then screw the leg through the fifth hole from the straight edge of the connector and turn the leg until securely tightened. Then install the two legs on the other side of the second base, these do not require connectors.

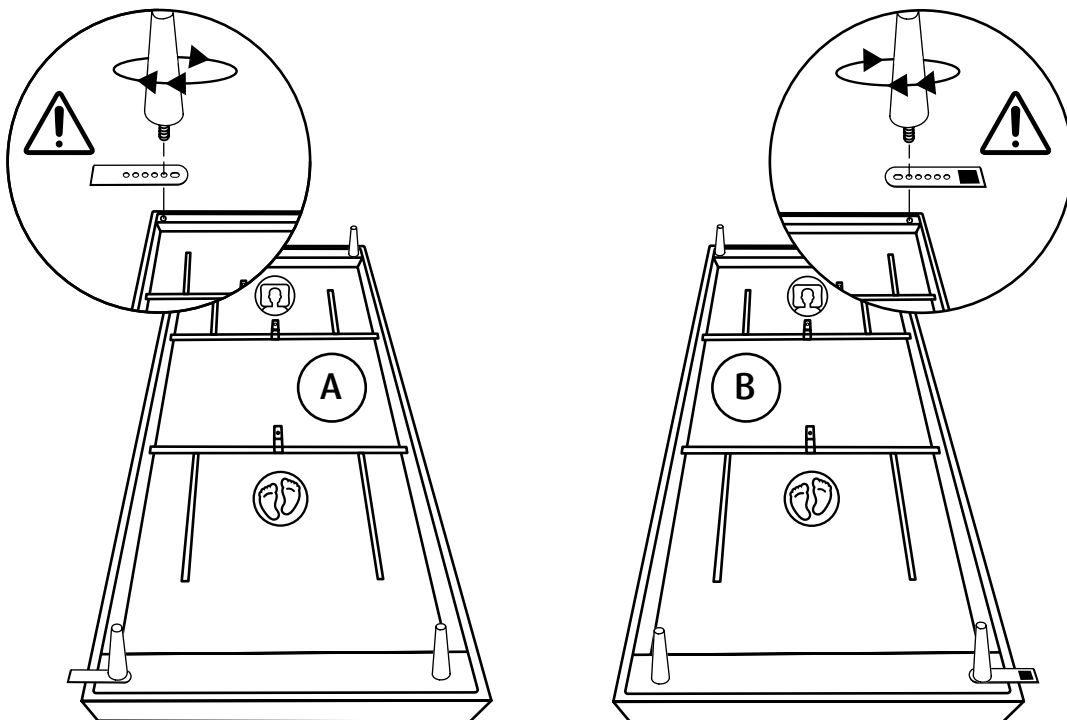

2. To install the motor

Slide the catches off the top of the motors. Take note of where the motor indicates the head and foot ends. Head and foot markings are shown on the image below.

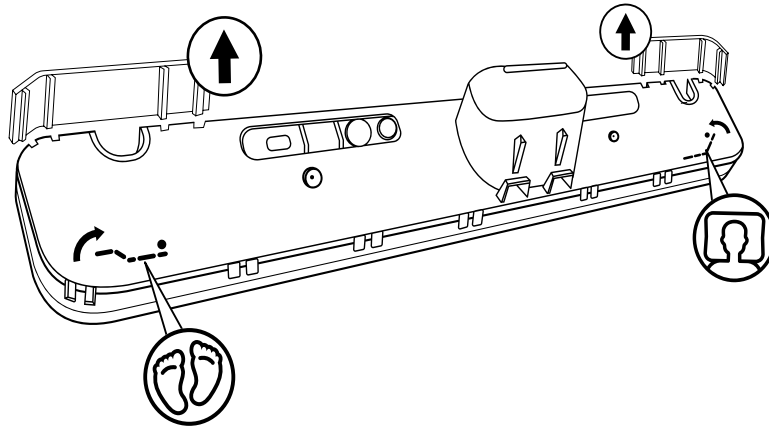

3. Install the motors to both bed bases.

Install the motor as per the image slotting into the brackets in the middle of the base. Push the motor downwards until it is secure. Repeat the step for the second half of the frame.

IMPORTANT

Follow the markings on the motors and bed bases to ensure that motor is installed in correct way. Head- and foot-end markings must match on motor and bed base.

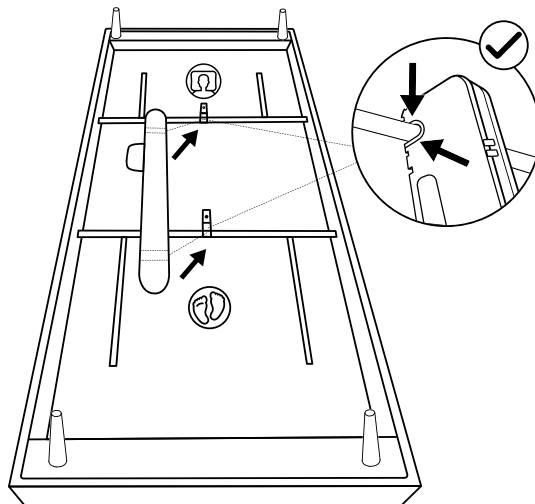

4. Slide the catches back into the motors.

Slide the catches back onto the motor to lock into place as per the image below. Repeat the step for the second half of the frame.

IMPORTANT

Make sure catches are inserted correctly and motor is firmly connected.

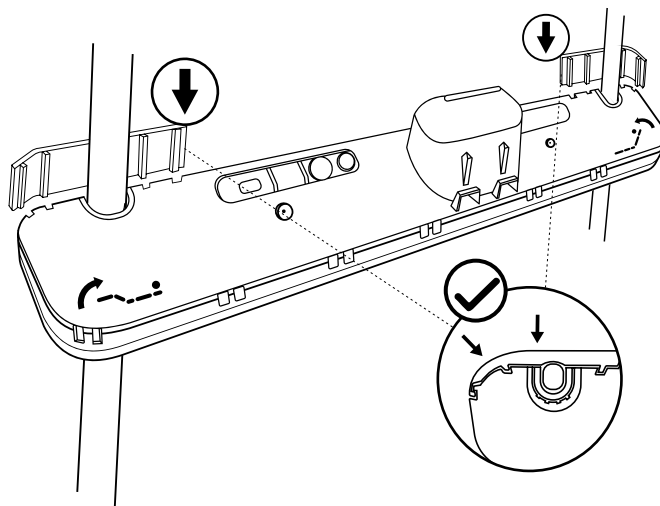

5. Attach the power cord to both motors.

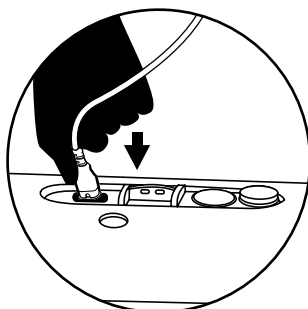

6. Insert the batteries to both remote controls, ensuring they are inserted correctly.

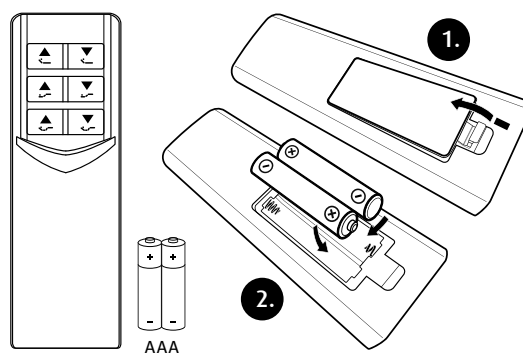

7. Syncing the remote control to a motor.

Whilst being no more than 2 meters from the base, follow the next steps to sync the first motor and the remote:

1. Connect the motor to the power supply.
2. Press the button on the motor twice, as show in image 2. The button will then light up.
3. Within 20 seconds, press the two top buttons on the remote until the light on the button on the motor goes off.

Repeat the steps for the second remote and second motor.

After syncing turn both of the bed bases over onto their feet.

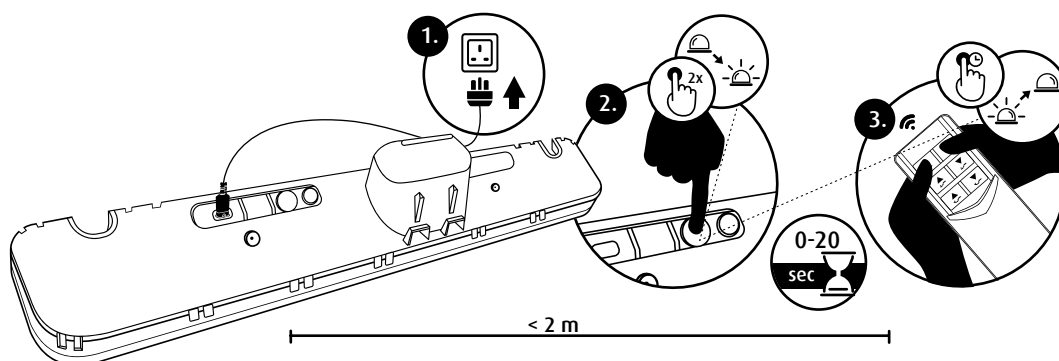

OPTION

If you would like to use one remote to control the entire bed, take the remote you would like to control both motors and follow the steps below:

1. Push the button on the motor which hasn't yet been synced until the button lights up.
2. Within 20 seconds push the two middle buttons on the remote until the light goes out.

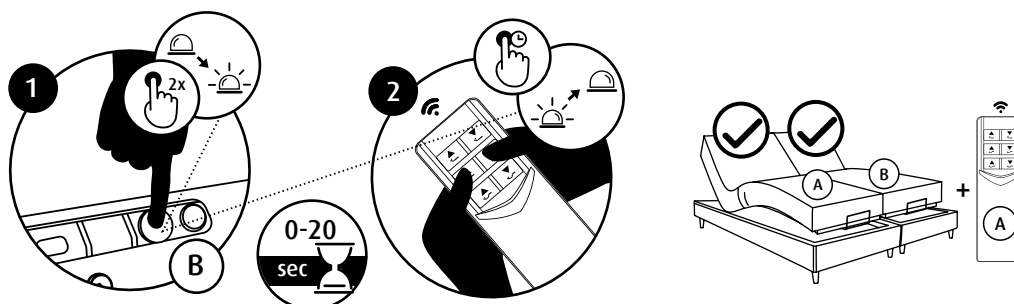

8. Connect the two bed bases together.

Using two people put both bed bases on an even surface with the connecting plates facing each other. Push the beds together and then overlap the connectors to link the velcro pads. Push the velcro pads together to secure.

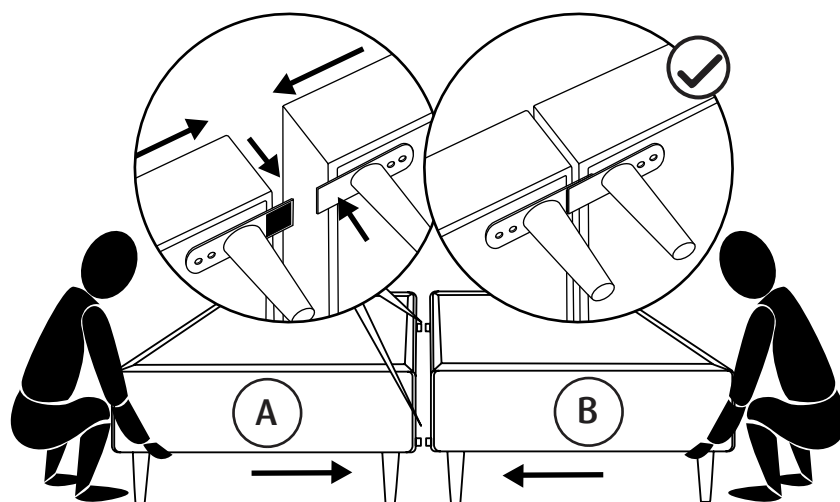

9. Install the foot end mattress retainers. Optional - you can also add side retainers.

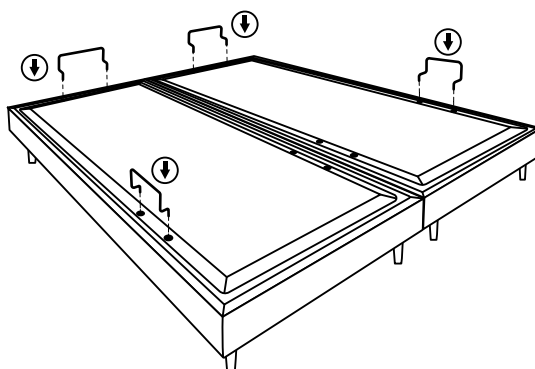

10. You are now ready to place the mattresses onto the bed.

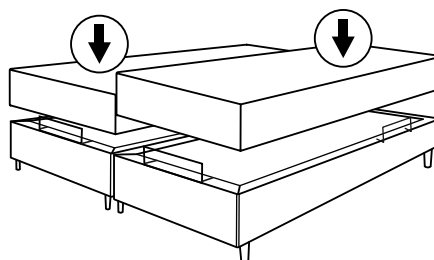

Buttons on your remote.

Two upper buttons control the head-end - left button rises and right button lowers the head-end.

Two middle buttons control the foot-end - left button rises and right button lowers the foot-end.

Two bottom buttons control both the head-end and foot-end together - left button rises and right button lowers both.

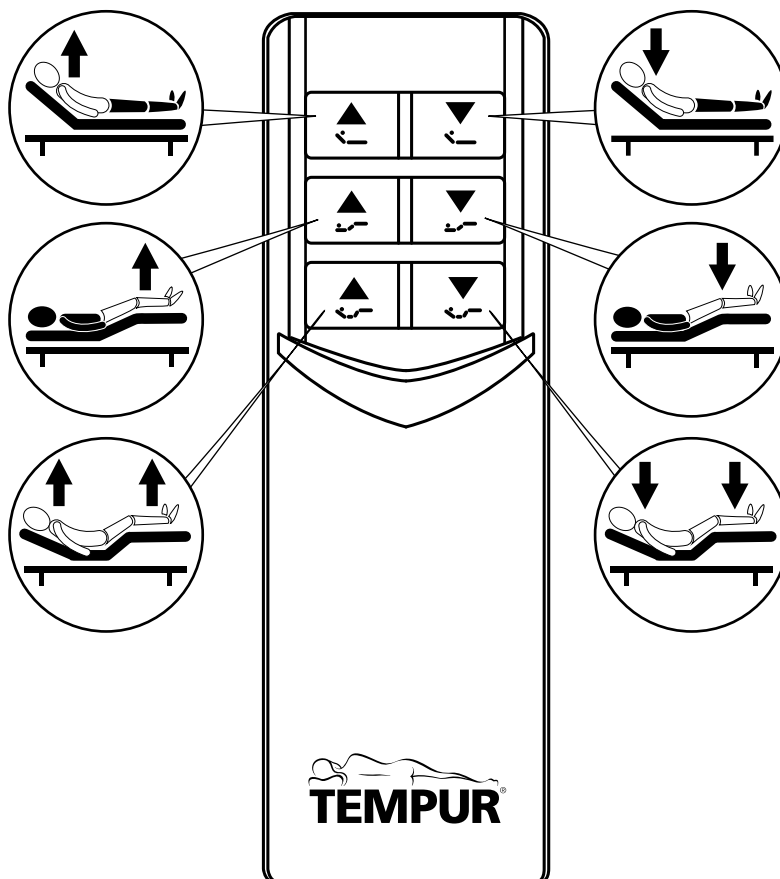

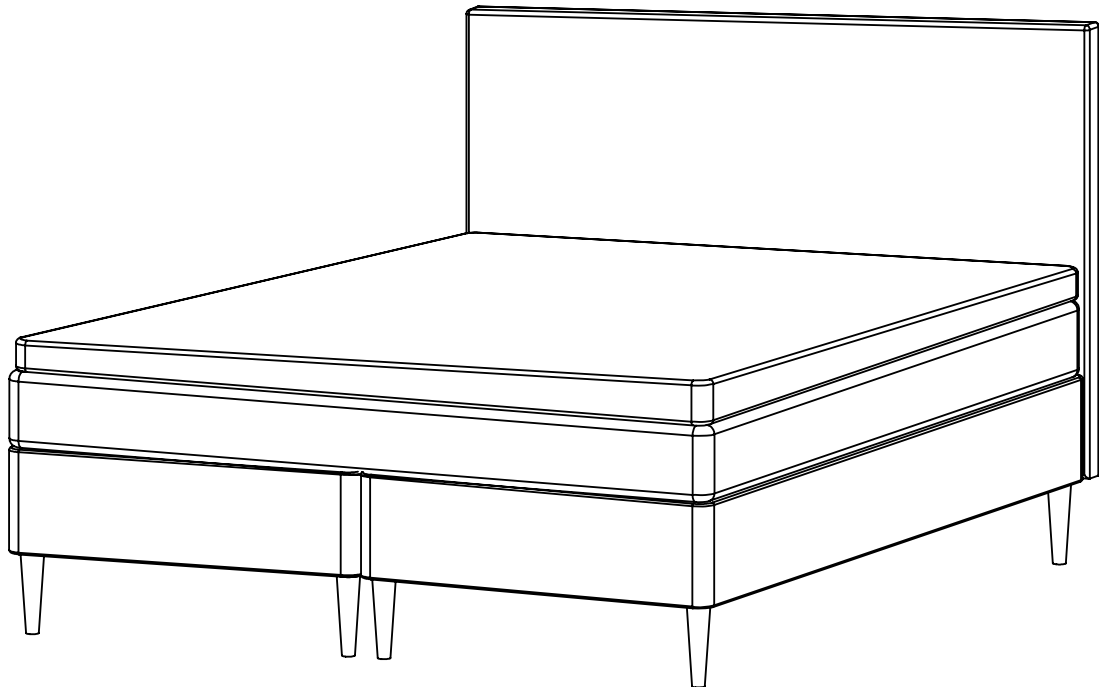
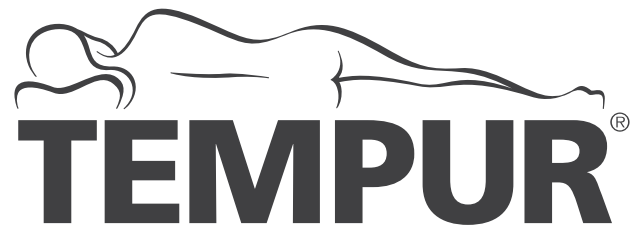

TEMPUR FORM™ Bed range

Headboard assembly guide



CAUTION

The assembly instructions must be followed closely to install the bed system successfully, safely, and to minimize the risk of personal injuries and damage to the product.



Assemble the product with a minimum of two people.



Open the packaging carefully to prevent causing damage to the product. Dispose of the packaging safely and as sustainably as possible in your local area.

Component list

Check all the components. All the tools needed for assembly come with the product.

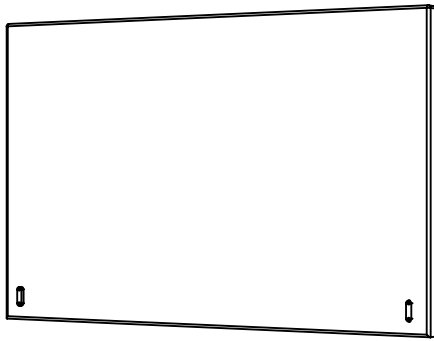

1x headboard

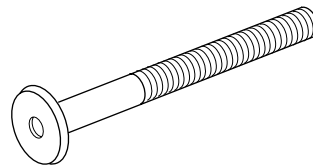

2x M4 screw

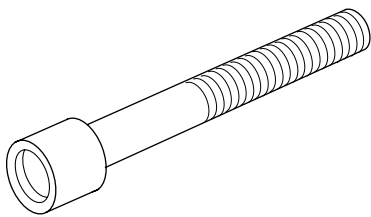

2x M6 screw

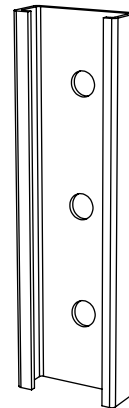

2x mounting
bracket

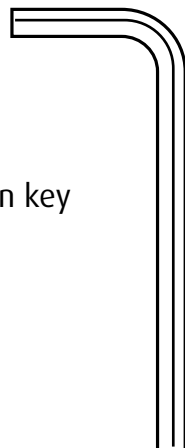

1x M6 Allen key

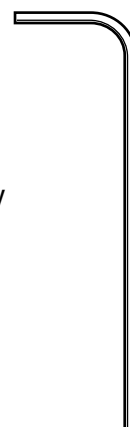

1x M4 Allen key

1. Install the mounting brackets.

At the head end of the base using the tools provided, screw the mounting bracket into the holes as per the image. Using the M4 screw for upper hole and M6 screw for the bottom hole. Repeat this for both outer sides of each base.

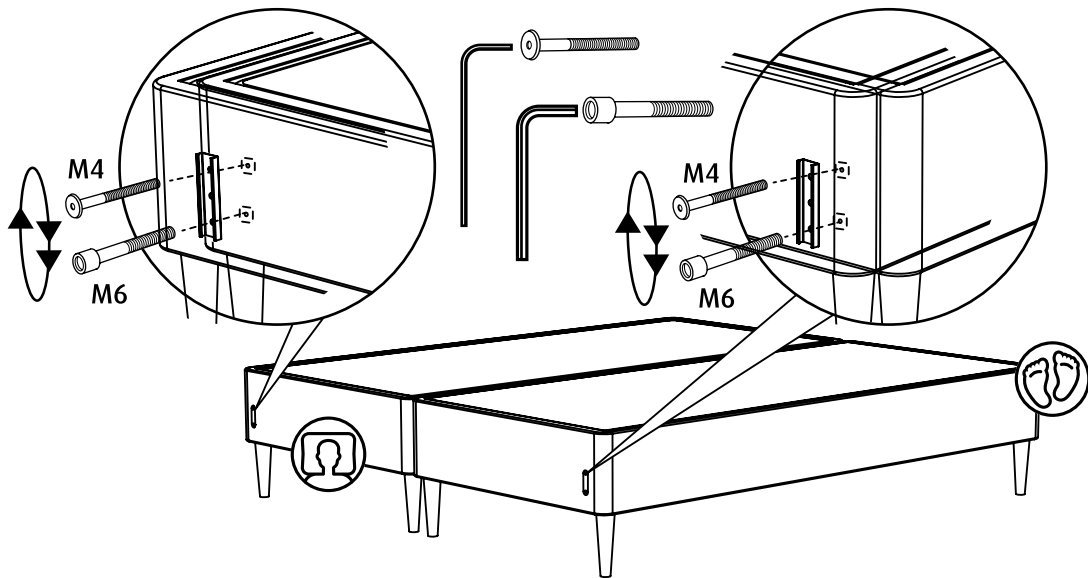

2. Attach the headboard.

By using two people, slide the headboard connectors into the corresponding mounting brackets on the bed until the headboard connector is fully in position.

IMPORTANT

If you need to reposition your bed, please do so by adjusting from the base rather than the headboard.

